

# Assembly Instructions

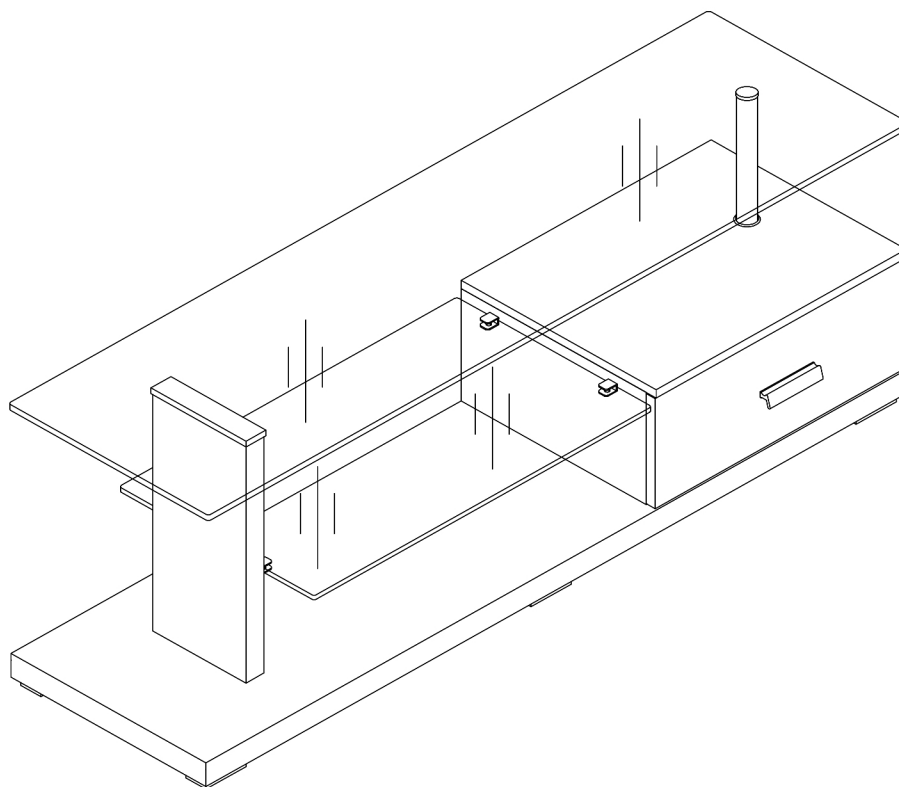

## ASSEMBLY RATING

The Assembly Rating is a 5-point system that shows the degree of effort needed in assembling a specific product (with 1 being easy and 5 being difficult). For some products, two persons are recommended.

EASY  DIFFICULT

## Tools Required For Assembly:

Allen Wrench

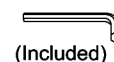

Wrench



Phillips Screwdriver



2 PERSONS RECOMMENDED

# ASSEMBLY & CARE ADVICE

FOR YOUR FURNITURE TO LAST, CORRECT ASSEMBLY AND PROPER MAINTENANCE ARE NECESSARY. PLEASE FOLLOW THE INFORMATION PROVIDED BELOW TO FULLY ENJOY YOUR FURNITURE.

## BASIC ASSEMBLY TECHNIQUES

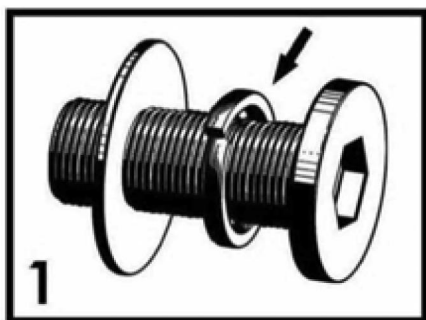

When lock or spring washer is used in an assembly, please make sure the lock or spring washer is placed between the larger flat washer and the head of the screw or bolt.

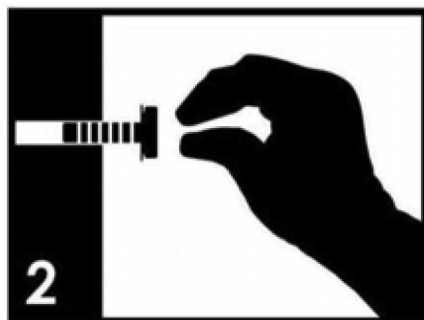

Position each part correctly and insert screws or bolts into their respective holes by hand tighten or using the proper hand tool. Only tighten when step is completed or when instructed to do so.

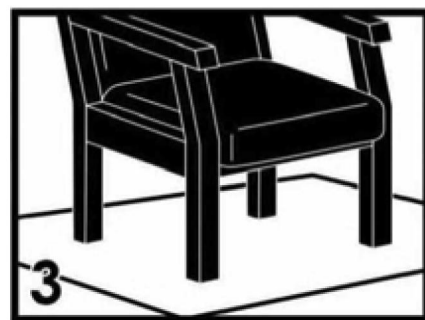

Use cardboard or carpet area when assembling furniture to prevent scratches. Make sure the furniture rests on a flat and level surface with each leg evenly touching the floor.

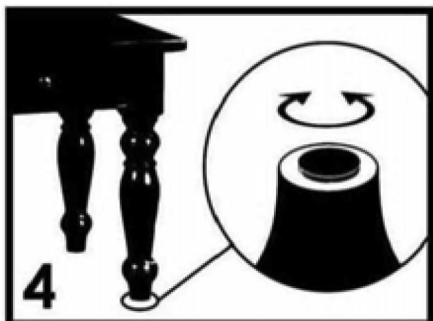

Some furniture comes with height adjustment knobs underneath each leg. To lower or to raise each leg, you need to turn clockwise or counterclockwise, respectively.

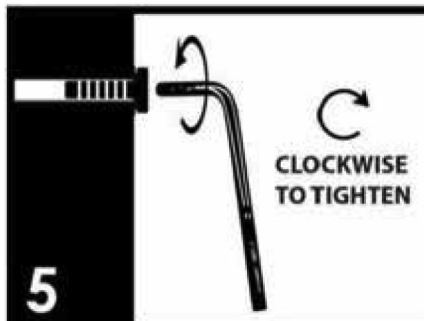

Make sure all parts are properly aligned, then use the appropriate hand tool to completely tighten the bolts or screws. Do not use power tools and do not overtighten.

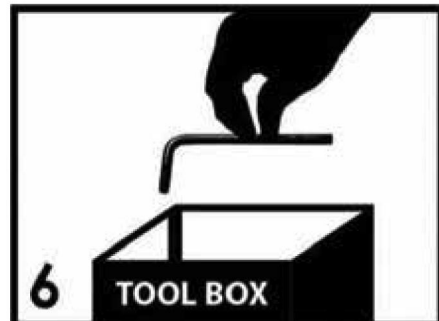

Save the instructions and store the Allen wrench or any supplied tool for later maintenance. After two weeks, check and tighten any loose hardware and repeat again every six months thereafter.

IT IS THE USER'S RESPONSIBILITY TO MAINTAIN THE FURNITURE. THE HARDWARE MAY LOOSEN OVER TIME AND MAY CAUSE THE FURNITURE TO BE WOBBLY AND UNABLE TO SUPPORT ITS INTENDED WEIGHT CAPACITY. THIS MAY LEAD TO COLLAPSE AND MAY CAUSE SERIOUS INJURY.



FAILURE TO FOLLOW THE GUIDELINES ABOVE MAY RESULT IN INJURY AND/OR PROPERTY DAMAGE.



Before you begin, please read Page 2 of "Assembly and Care Advice".

And remember, do not tighten until each step is completed or instructed.

## Parts List

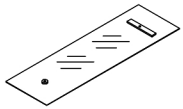

#1 x 1pc  
Glass Top

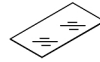

#2 x 1pc  
Glass Shelf



#3 x 1pc  
Pole



#4 x 1pc  
Shelf Leg

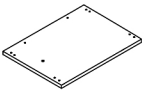

#5 x 1pc  
Top Panel

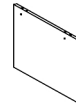

#6 x 1pc  
Left Panel

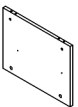

#7 x 1pc  
Right Panel

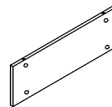

#8 x 1pc  
Back Panel



#9 x 1pc  
Drawer Left Panel



#10 x 1pc  
Drawer Right Panel



#11 x 1pc  
Drawer Back Panel

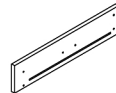

#12 x 1pc  
Drawer Face Panel

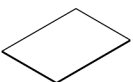

#13 x 1pc  
Drawer Bottom Panel

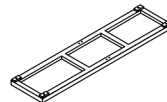

#14 x 1pc  
Bottom Panel



#15 x 2pcs  
Bottom Cap



Before you begin, please read Page 2 of "Assembly and Care Advice".

And remember, do not tighten until each step is completed or instructed.

## Hardware List



#A x 2pcs  
Stud bolt 5/16"X17-3/4"



#C x 8pcs  
Cam Lock Ø14.5



#E x 12pcs  
Cam Lock Ø12.5



#G x 10pcs  
Wood Dowel Ø6X30mm



#I x 3pcs  
Hex Nut



#K x 4pcs  
Glass Shelf Bracket



#M x 2pcs  
Screw M4 X 22mm



#O x 8pcs  
Screw M4 X 10mm



#Q x 1pc  
Cap



#S x 1pc  
Allen Wrench M4



#B x 1pc  
Stud bolt 5/16"X 9-1/2"



#D x 8pcs  
Cam bolt 1/4" X 1-1/2"



#F x 12pcs  
Cam bolt 1/4" X 15/16"



#H x 4pcs  
Screw M5 X 12mm



#J x 3pcs  
Flat Washer Ø18



#L x 1pc  
Drawer handle



#N x 2pcs  
Drawer Rails 36x350



#P x 2pcs  
Bolt 1/4"X 3/4"



#R x 1pc  
Socket Wrench M8



#A x 2pcs  
#B x 1pc  
#Q x 1pc

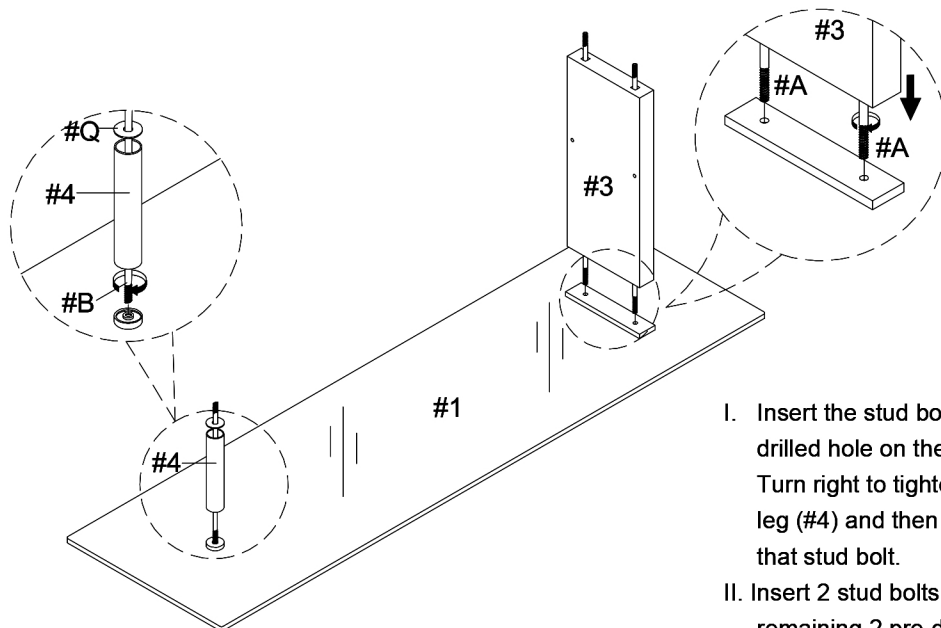

- I. Insert the stud bolt (#B) into a pre-drilled hole on the glass top (#1). Turn right to tighten. Insert the shelf leg (#4) and then the cap (#Q) onto that stud bolt.
- II. Insert 2 stud bolts (#A) into the remaining 2 pre-drilled holes on the glass top (#1). Turn right to tighten. Then insert the pole (#3) onto those bolts.



#C x 4pcs  
#D x 4pcs  
#E x 2pcs  
#F x 2pcs  
#G x 4pcs  
#O x 4pcs  
#N x 2pcs

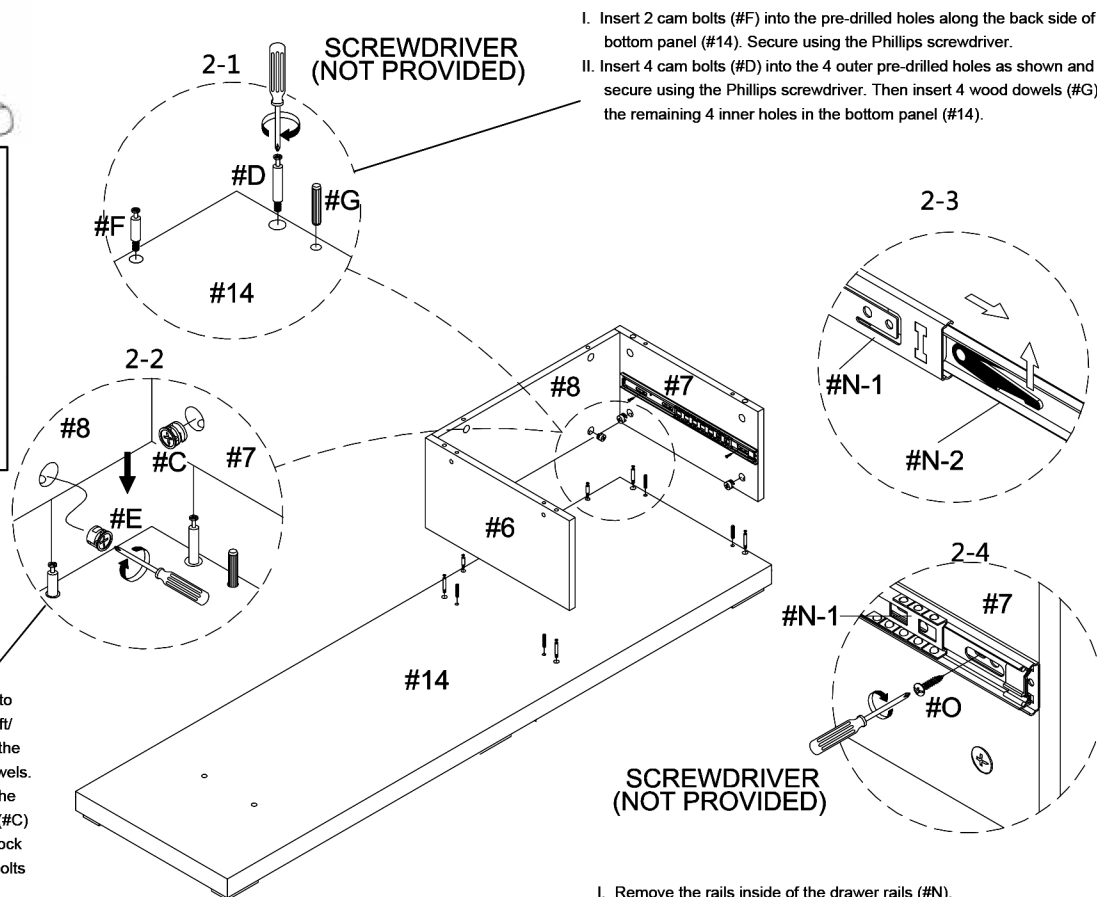

- I. Insert the back panel (#8) onto the cam bolts (#F) and the left/right side panels (#7/6) onto the cam bolts (#D) and wood dowels.
- II. Insert 2 cam locks (#E) into the back panel and 4 cam locks (#C) into the side panels (#7/6). Lock the cam locks with the cam bolts using a Phillips screwdriver.

- I. Remove the rails inside of the drawer rails (#N).
- II. Align the drawer rails (#N) to the pre-drilled holes along the sides of the side panels (#7/6) and insert 2 screws (#O) into each rail. Secure using a Phillips screwdriver.



#C x 4pcs  
#D x 4pcs  
#E x 2pcs  
#F x 2pcs  
#G x 4pcs

SCREWDRIVER  
(NOT PROVIDED)

3-1

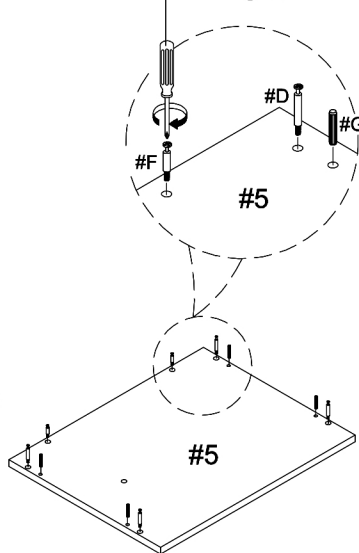

3-2

SCREWDRIVER  
(NOT PROVIDED)

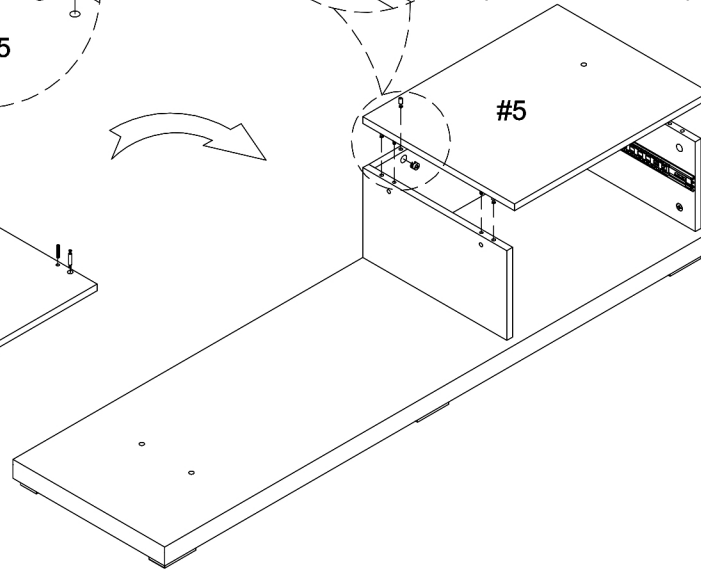

- I. Insert 2 cam bolts (#F) into the pre-drilled holes along the back side of the top panel (#5). Secure using the Phillips screwdriver.
- II. Insert 4 cam bolts (#D) into the outer corner pre-drilled holes of the top panel (#5) as shown and secure using a Phillips screwdriver. Then insert 4 wood dowels (#G) into the remaining holes of the top panel.
- III. Insert 2 cam locks (#E) into the back panel and 4 cam locks (#C) into the side panels (#7/6).
- IV. Insert the top panel (#5) onto the back and side panels. Lock the cam locks with the cam bolts using a Phillips screwdriver.



#G x 2pcs  
#I x 3pcs  
#J x 3pcs  
#P x 2pcs

- I. Apply the assembled bottom panel upside down onto the shelf leg and pole.
- II. Insert a flat washer (#J) and hex nut (#I) onto the threaded end of the stud bolts (#A). Secure using the socket wrench (#R).
- III. Insert a flat washer (#J) then hex nut (#I) onto the threaded ends of the stud bolt (#B) located on the leg. Secure using the socket wrench (#R).
- IV. Align 2 bottom caps (#15) to the pre-drilled holes along the sides of the bottom panel (#14). Insert bolts (#P) and secure using the Allen wrench (#S).

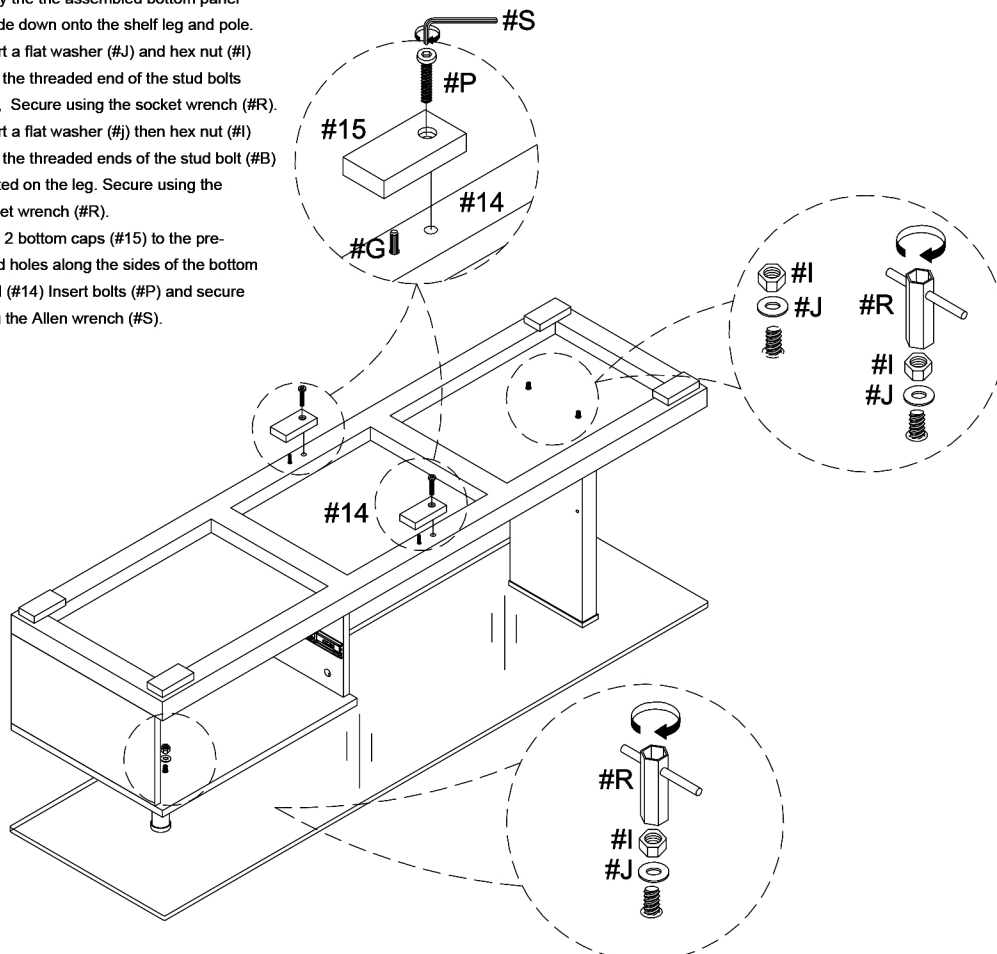



#5

#E x 8pcs

#F x 8pcs

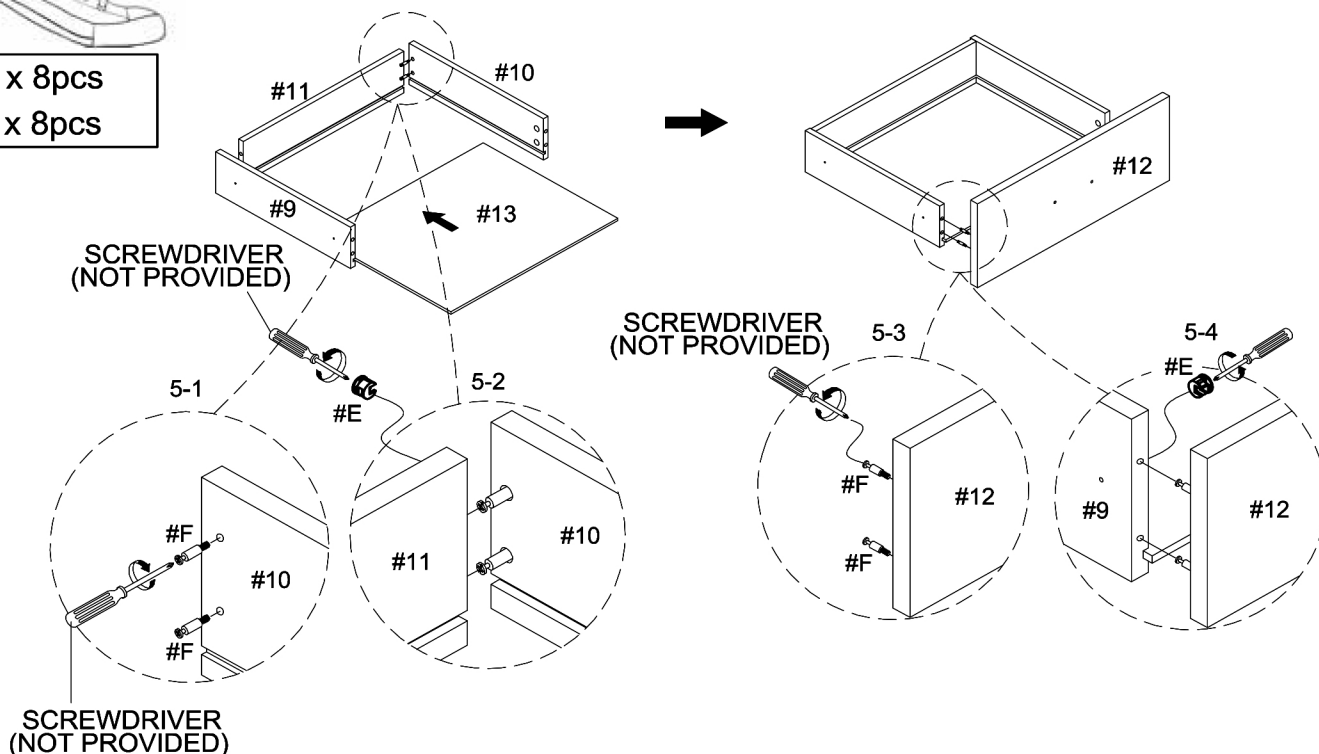

#6

#L x 1pc

#M x 2pcs

#O x 4pcs

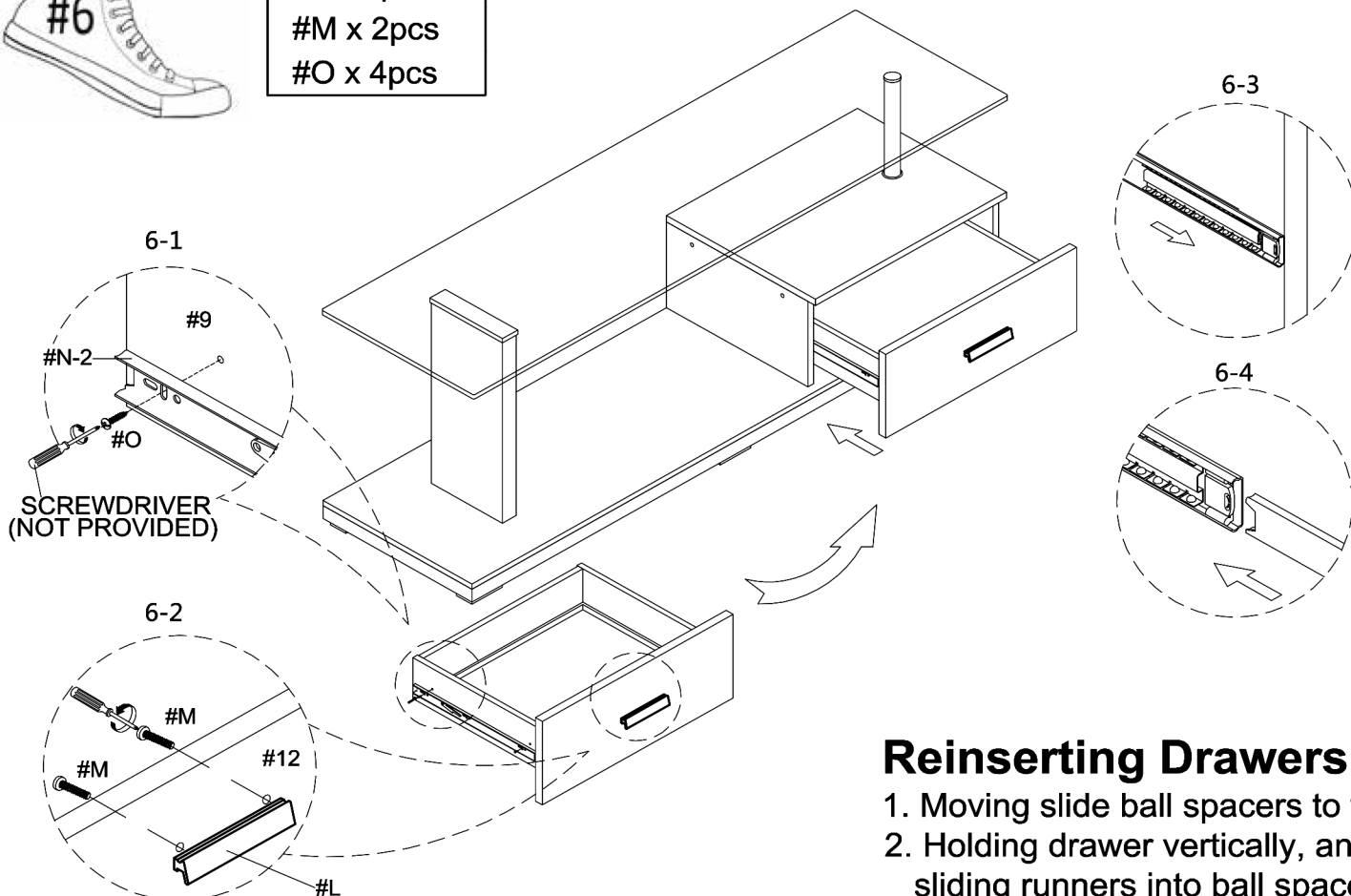

## Reinserting Drawers

1. Moving slide ball spacers to front.
2. Holding drawer vertically, and sliding runners into ball spacers.



#H x 4pcs  
#K x 4pcs

- I. Align the glass shelf brackets (#K) to the pre-drilled holes along the sides of the pole and side panel. Insert a screw (#H) into each bracket and secure using a Phillips screwdriver.
- II. Apply the glass shelf (#2) and secure using the Allen wrench (#S).

SCREWDRIVER  
(NOT PROVIDED)

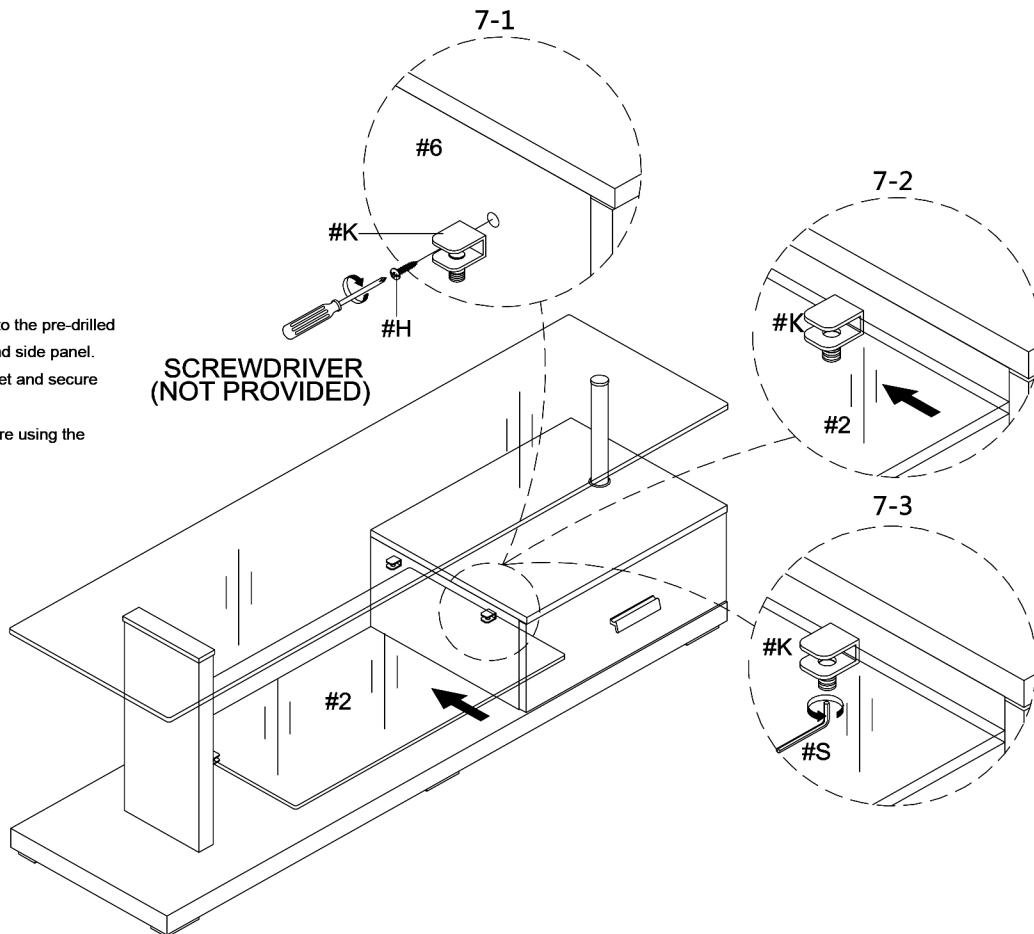

Make sure all bolts are firmly secured.

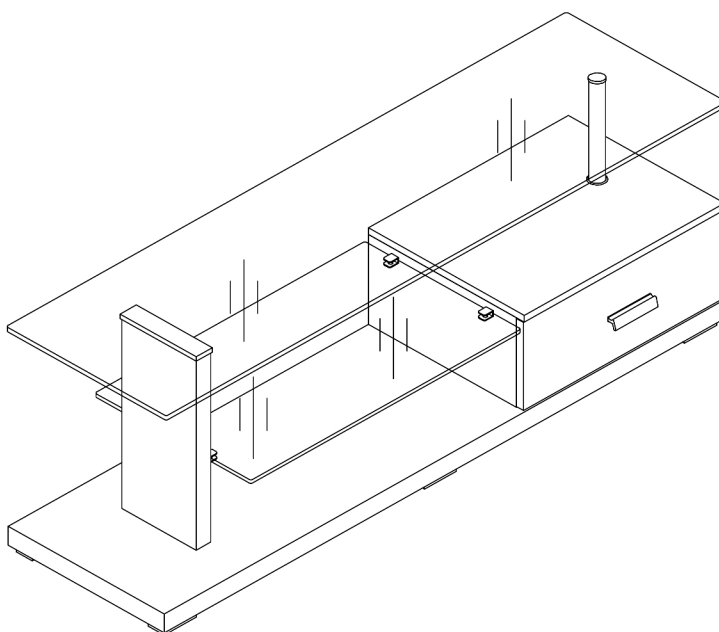

ASSEMBLY IS COMPLETED